

Easy Garage Shop Cabinets || Part 1-Lowers

By **Castor Woodworks**

Difficulty

Moderate

Learn how to build lower cabinets for your shop!

This build is perfect for a beginner builder that wants to learn the basics of cabinet construction. You can practice in your garage and eventually move on to building some for your kitchen, office, etc...

Follow along!

<http://bit.ly/MiterSawStation>

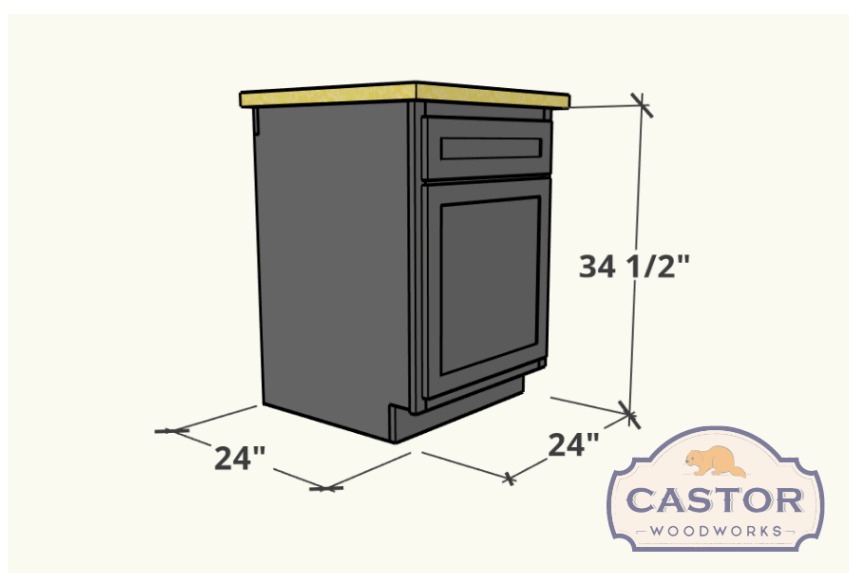

Tools

Other Tools

Miter Saw

Table Saw

Materials

Wood Products

1 Plywood , 3/4" Thick , Half Sheet

Hardware & Supplies

1 1 1/4" Pocket Screws

Cut List & Parts

2 Sides , 34 1/2" X 23 3/4" X 3/4"

Directions

1

Review the Entire Plan

I'd like to start out with the concept of building cabinets this way. the standard sizing for kitchen cabinets is 34 1/2" Tall by 24" wide by 24" deep. You can easily modify your cabinets by simply changing the width. And you can place them side by side to make a continuous wall of cabinets.

The idea is you can place them in any configuration to suit your needs. In my case I'll be adding a miter saw in between two 24" cabinets and one 18" cabinet like the picture.

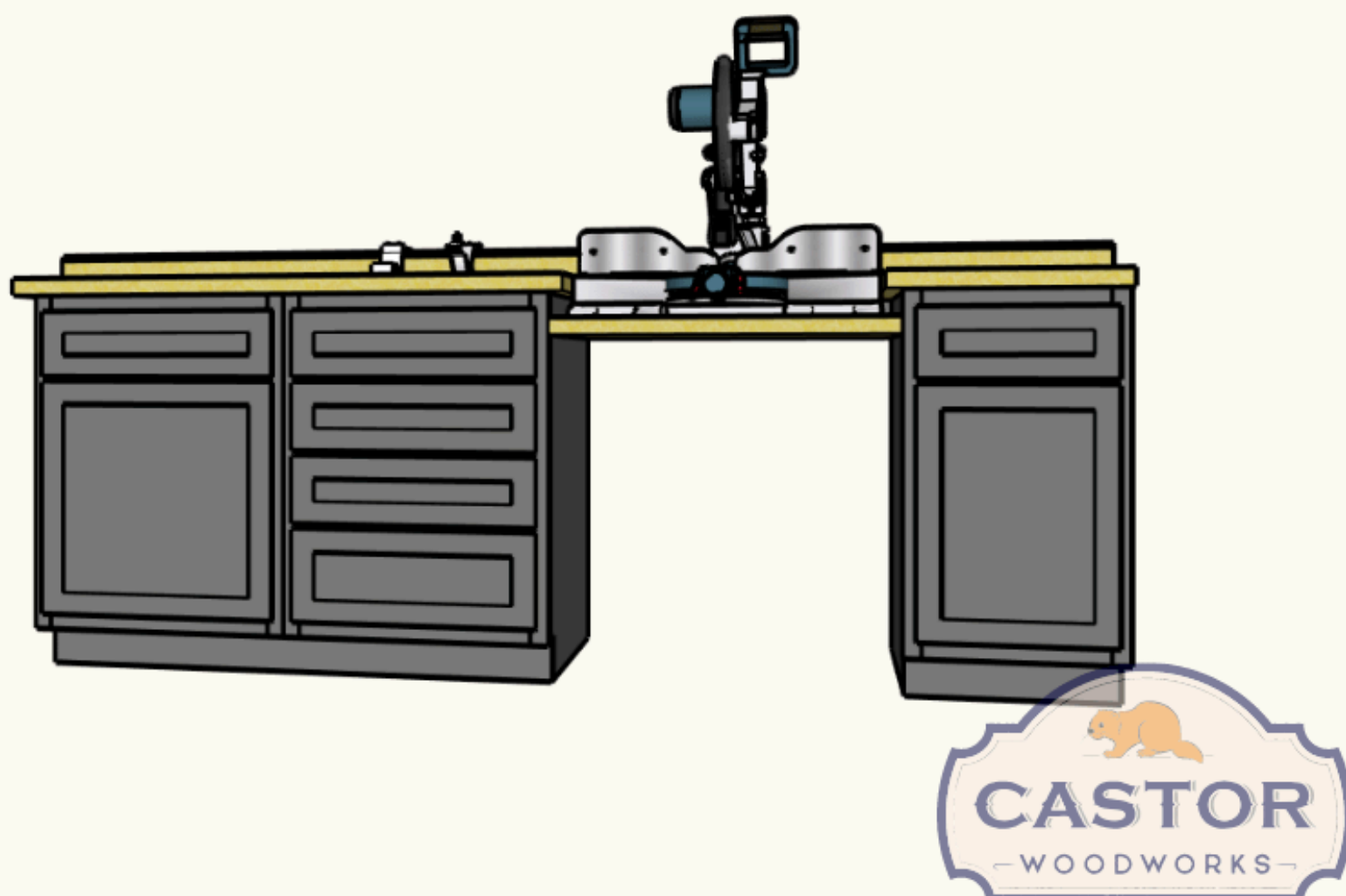

2

Complete Cut List

Use the cut-list to break down 3/4" plywood to the specified dimensions. You could also use MDF just make sure you the stock you use is nice and flat.



3**Add Toe kick to sides**

Once you have your sides cut, use a jig saw to cut your Toe kicks.

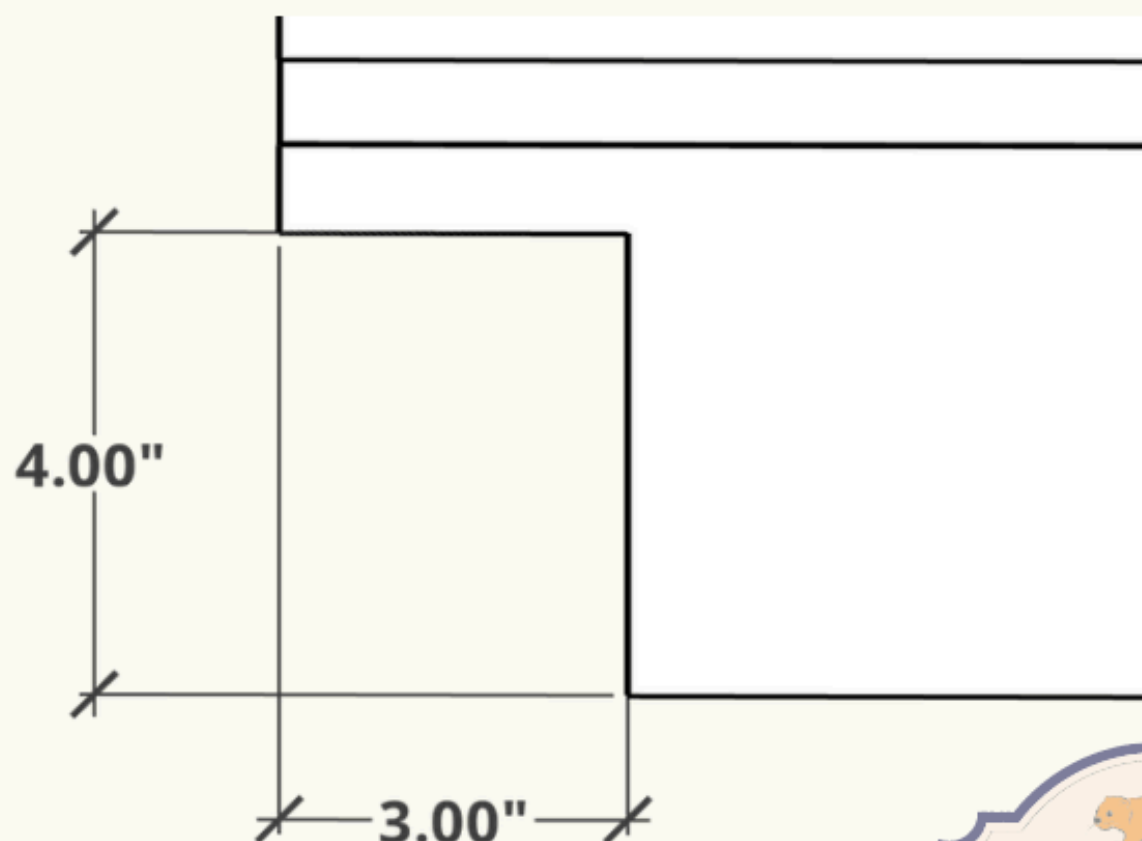

4**Cut Grooves in Sides**

Once your sides are cut, use your router to make a $\frac{3}{4}$ " groove $\frac{1}{4}$ " deep and $4\frac{3}{4}$ " up from the base of the cabinet.

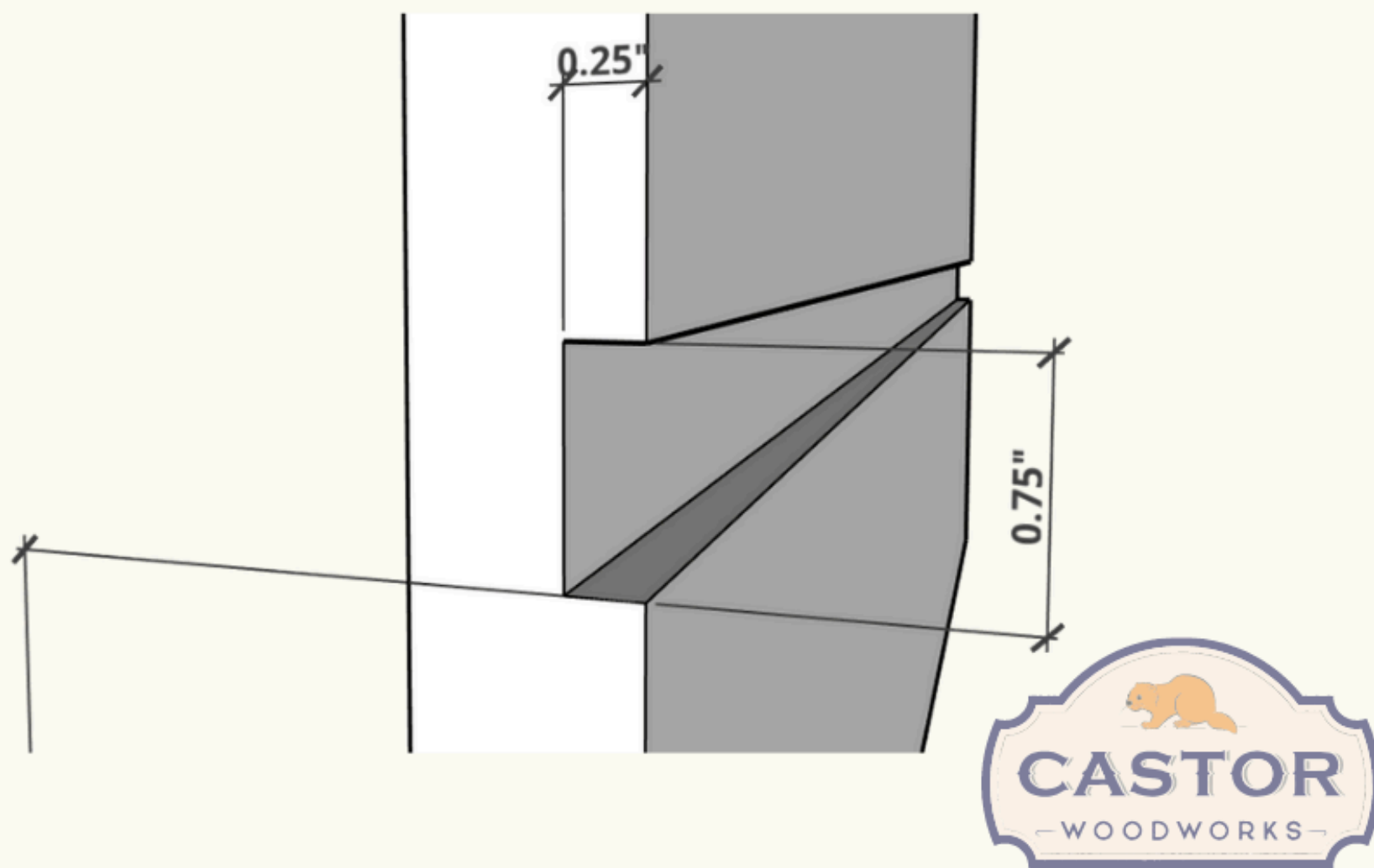

5**Assemble Cabinet**

Start assembly of the cabinet by sliding the Bottom Shelf into the groove on your Sides. Secure the shelf by countersinking 3-4 drywall screws on the outside of the sides along the line where the shelf will sit. This will hold the shelf in place and start to square it up.

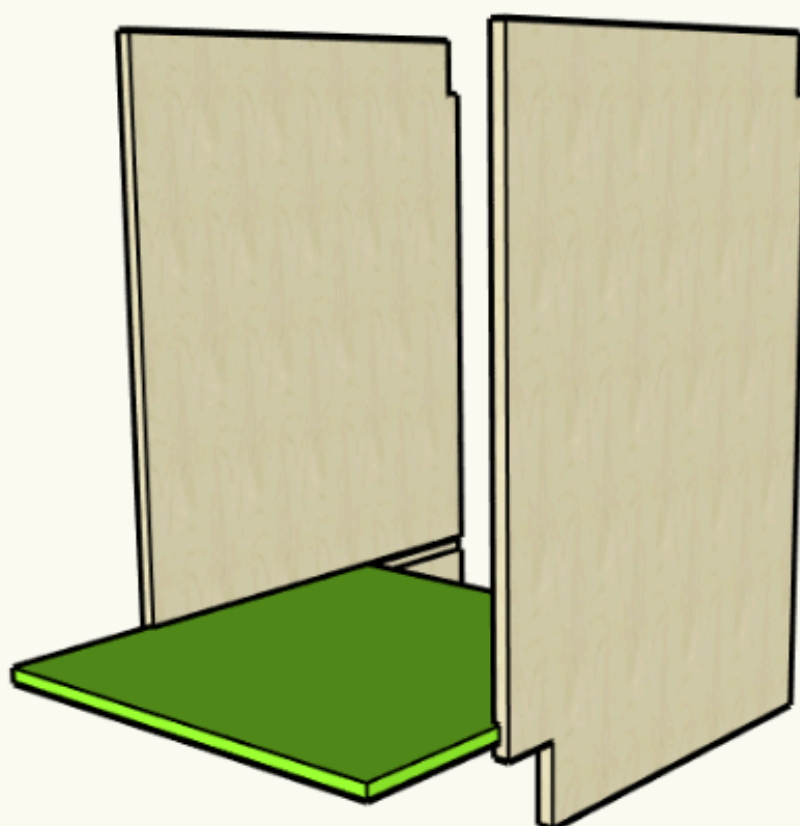

6**Attach Front Stretcher**

Attach the front Stretcher with either 1 1/4" pocket screws or from the outside with drywall screws.

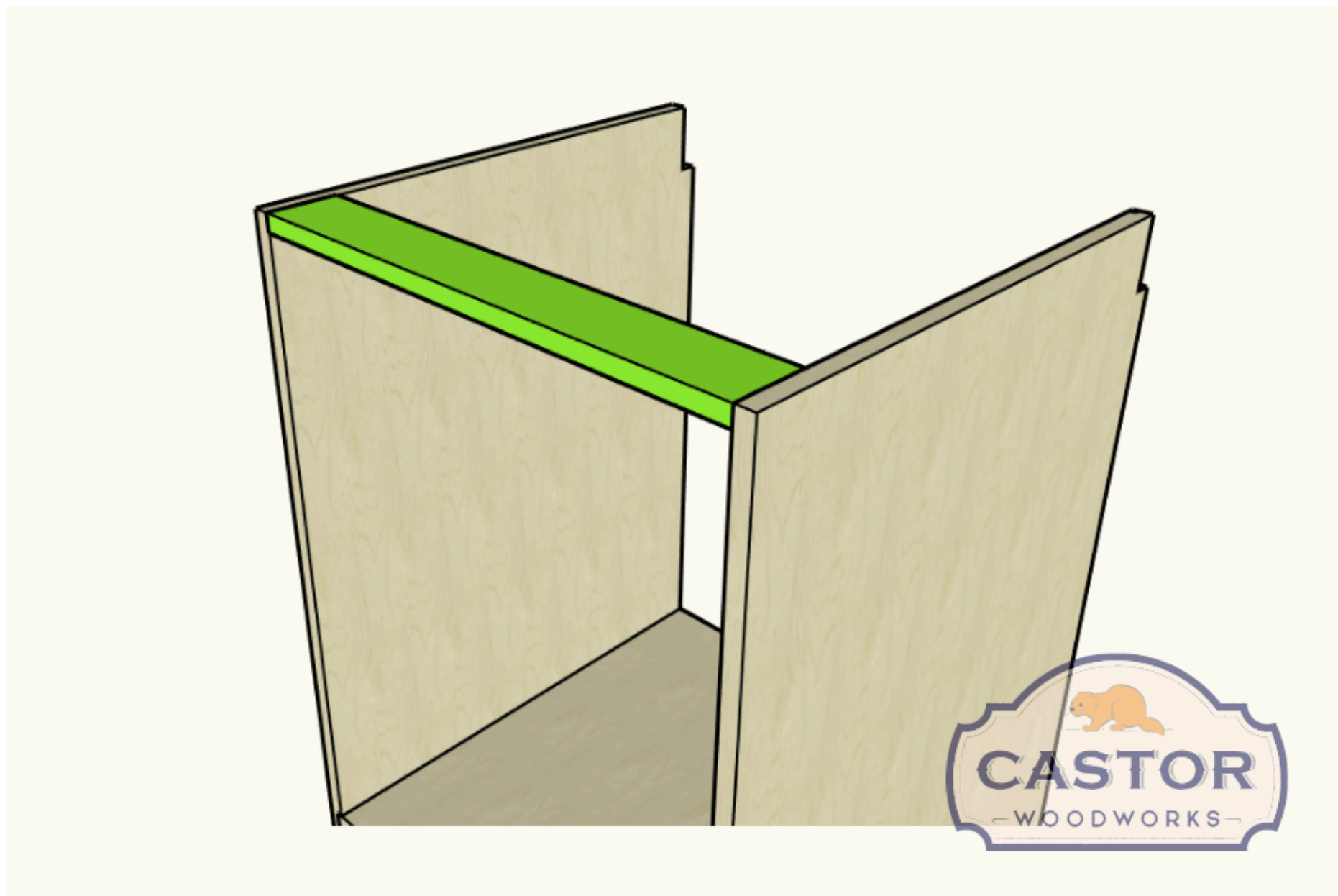

7**Create Notch for Back Stretcher**

Use a jig saw to cut out a notch for your back stretcher. This will help in case you ever need to assemble two or three cabinets together. You can make one long stretcher and use make one solid unit.

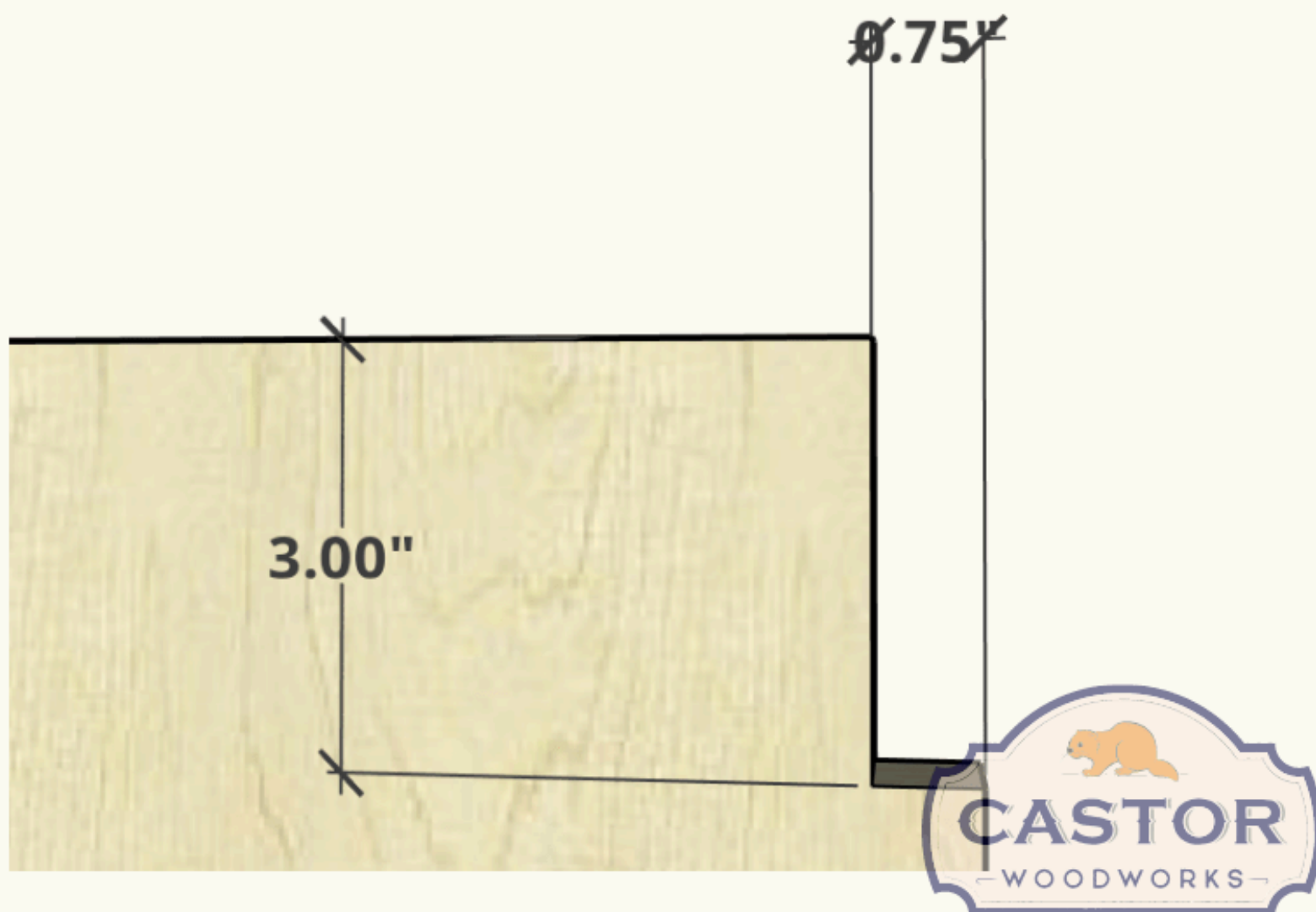

8**Attach Back Stretcher**

Attach the back stretcher to the sides using drywall screws. This will help lock your cabinet in to squareness and also allow for joining multiple cabinets together if necessary.

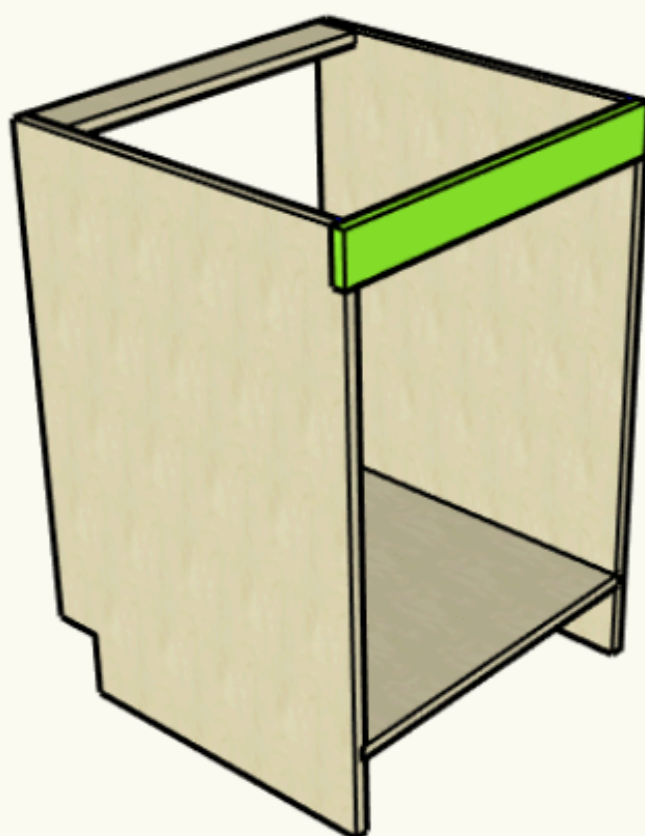

9**Cabinet assembly is done!**

At this point you have a strong base cabinet that is ready for the face frame! The face frame is what will dictate the style of cabinets you want. In my case I want one drawer and a door so I need have to stiles (vertical pieces) and three rails (short pieces).

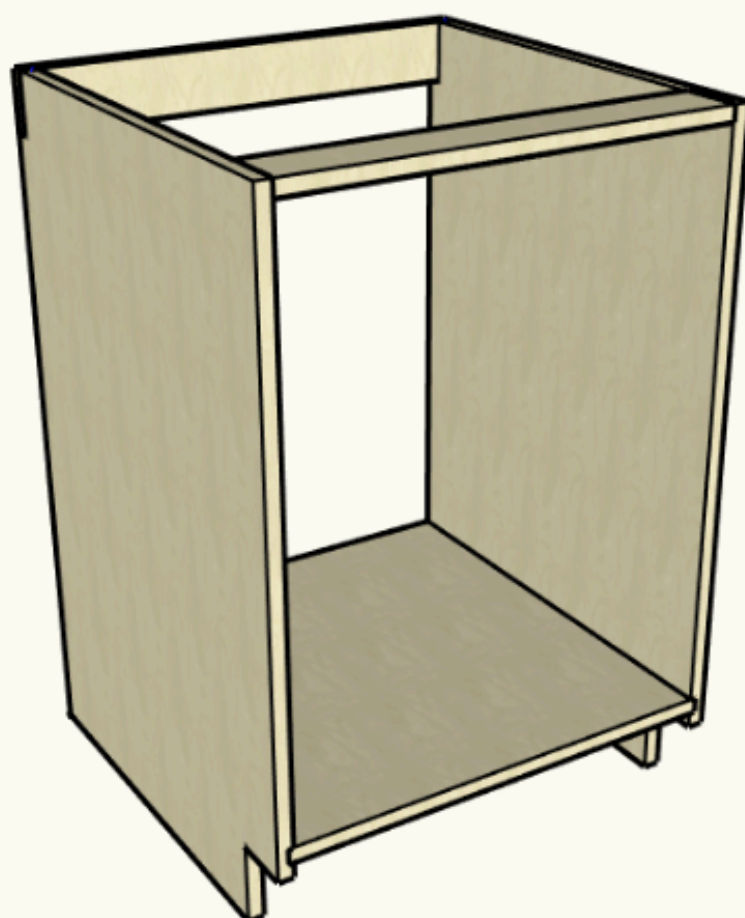

10**Assembly Face Frames**

Attach your rails to your stiles using 1 1/4" pocket hole screws and a dab of glue. Be sure to check for squareness throughout the process.

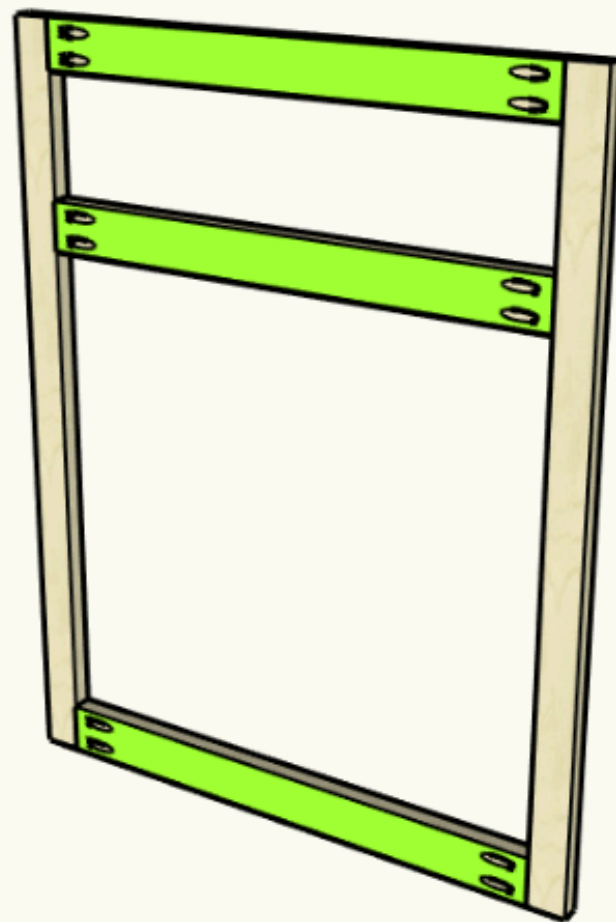

11**Note the Spacing**

Note that the spacing between the Top and Middle Rails will be 5".

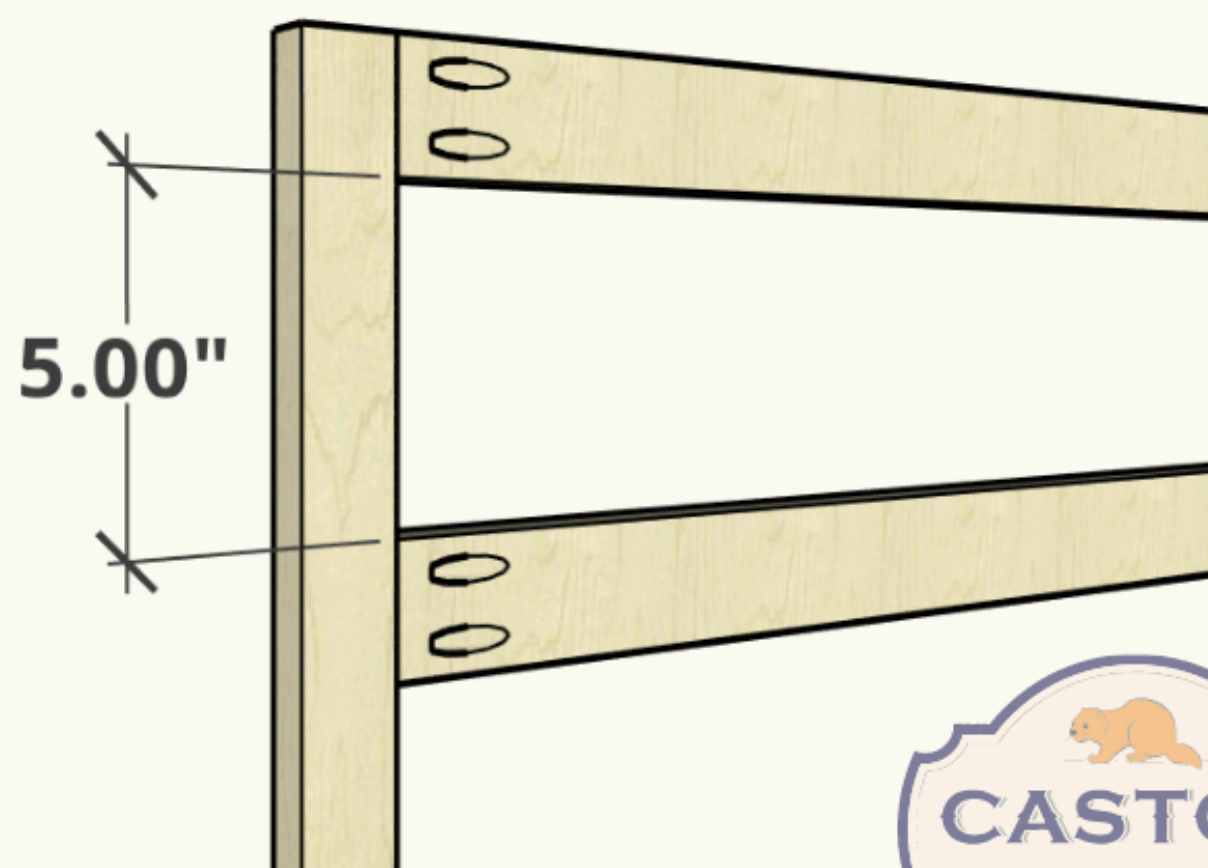

12**Attach Face Frame to Cabinet**

Flip the cabinet on its back and add a bead of glue to the Sides, Shelf and Front Stretcher and drop the Face Frame onto the cabinet. You can use a few pin nails to secure it in place. You can also add pocket holes to the inside of the sides and screw the face frame in for added stability.

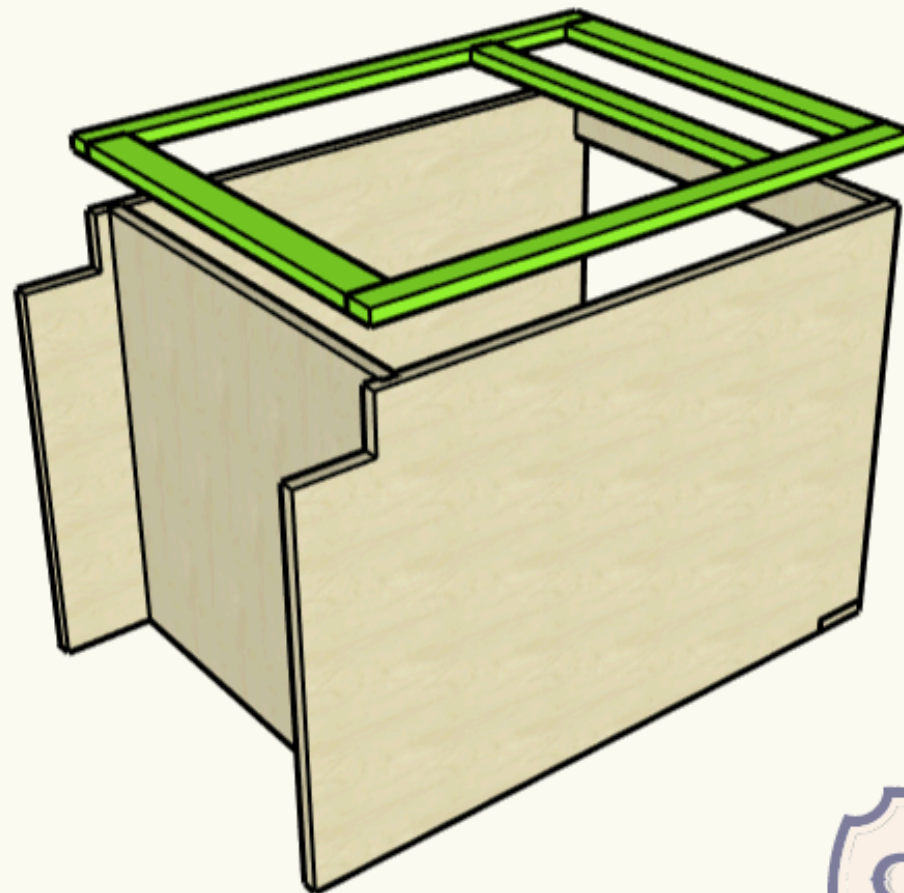

13**Add the Toe Kick**

Add the toe kick to the front of the cabinet. If you are lining up multiple cabinets together, now is a good time trim the toe kick to length. This will give the cabinets a clean finished look!

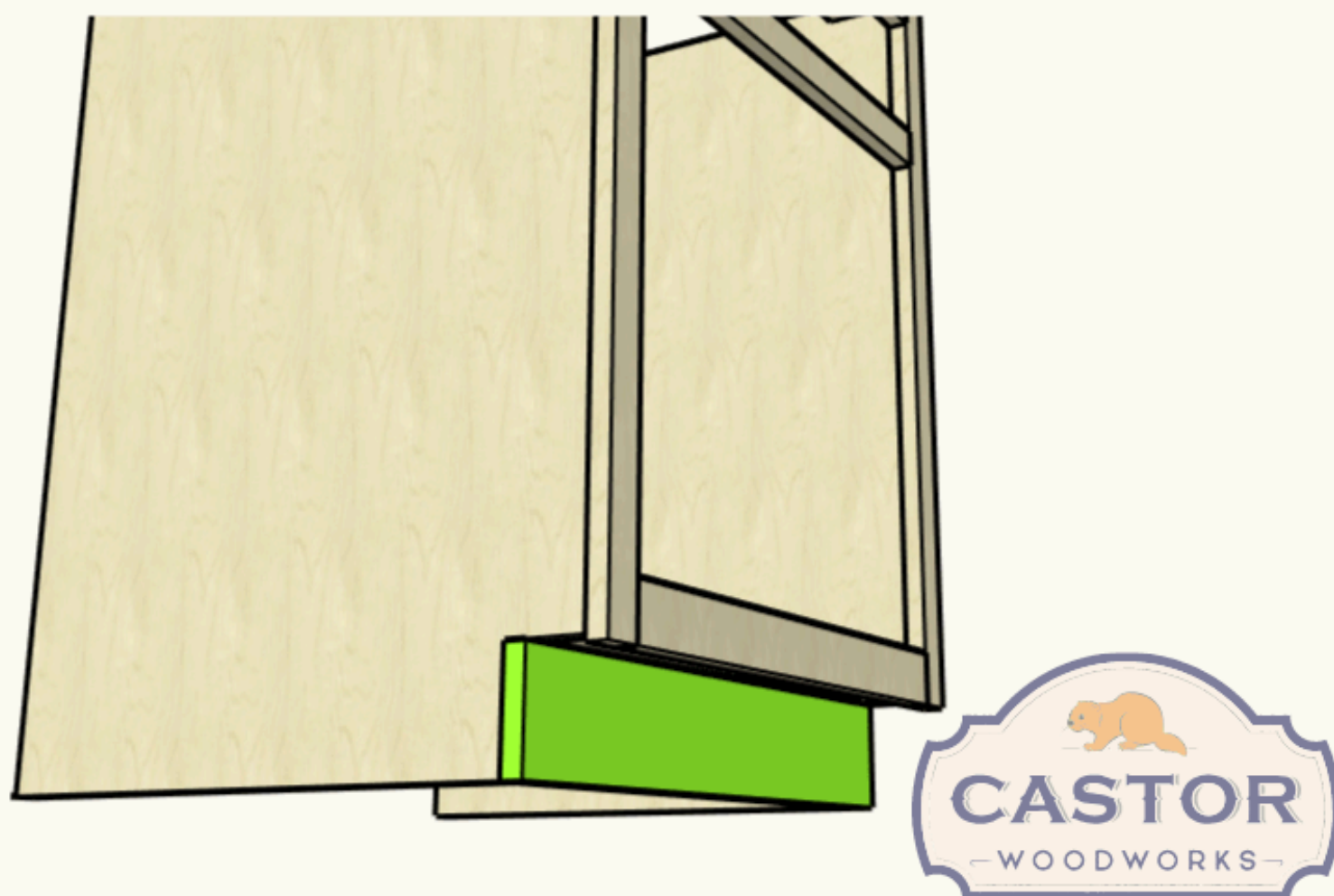

14**The Cabinet is Complete!**

Now the cabinet is complete! you can line up multiple cabinets side by side at this point. I will be covering the drawers, drawer front and doors in subsequent plans!

